

estate agents **auctioneers**



11 Barton Close, St. Annes Park, Bristol, BS4 4BA

£170,000

Hollis Morgan are pleased to offer this first floor one bedroom flat with allocated parking in the popular suburb of St Anne's. Offered Chain Free.

- Parking
- Ideal First Time Buy
- Ideal Investment
- First Floor Flat
- Chain Free

The Property

Hollis Morgan are pleased to offer this first floor one bedroom flat in the private estate of Barton Close with allocated parking in the popular suburb of St Anne's.

The property briefly comprises of separate kitchen to living space, good sized double bedroom, bathroom and hallway. The kitchen is equipped with a neat breakfast bar, ample white gloss wall and base units, space for fridge freezer, integrated hob/oven, washer/dryer and wood style work tops. The bedroom is carpeted and has plenty of space of free standing furniture. The bathroom is a three piece suite with a single shower cubicle, hand basin and w/c. The hallway is of good sized storage cupboard which contains the heating system.

Finally the property benefits from double glazing throughout and has an allocated off street parking space.

Location - St Anne's

The property is located within the popular suburb of St. Annes. Local amenities and services are all within walking distance. Bristol City Centre is approximately three miles away and Temple Meads only approximately two miles away.

Other Information

Management fees: £774.42 pa

Management Company: Woodridge Management Company Ltd

Tenure: Leasehold - 970 years

Parking: Allocated Off Street Parking (Space 30)

Ground rent: £50 pa

Please Note

Hollis Morgan endeavour to make our sales details clear, accurate and reliable in line with the Consumer Protection from Unfair Trading Regulations 2008 but they should not be relied on as statements or representations of fact and they do not constitute any part of an offer or contract. All Hollis Morgan references to planning, tenants, boundaries, potential development, tenure etc is to be superseded by the information provided in your solicitors enquiries. It should not be assumed that this property has all the necessary Planning, Building Regulation or other consents. Any services, appliances and heating system(s) listed may not been checked or tested and you should rely on your own investigations. The seller does not make any representation or give any warranty in relation to the property and we have no authority to do so on behalf of the seller. Please note that in some instances the photographs may have been taken using a wide angle lens.



Barton Close, St. Annes Park, Bristol, BS4

Approximate Area = 450 sq ft / 42 sq m

For identification only - Not to scale

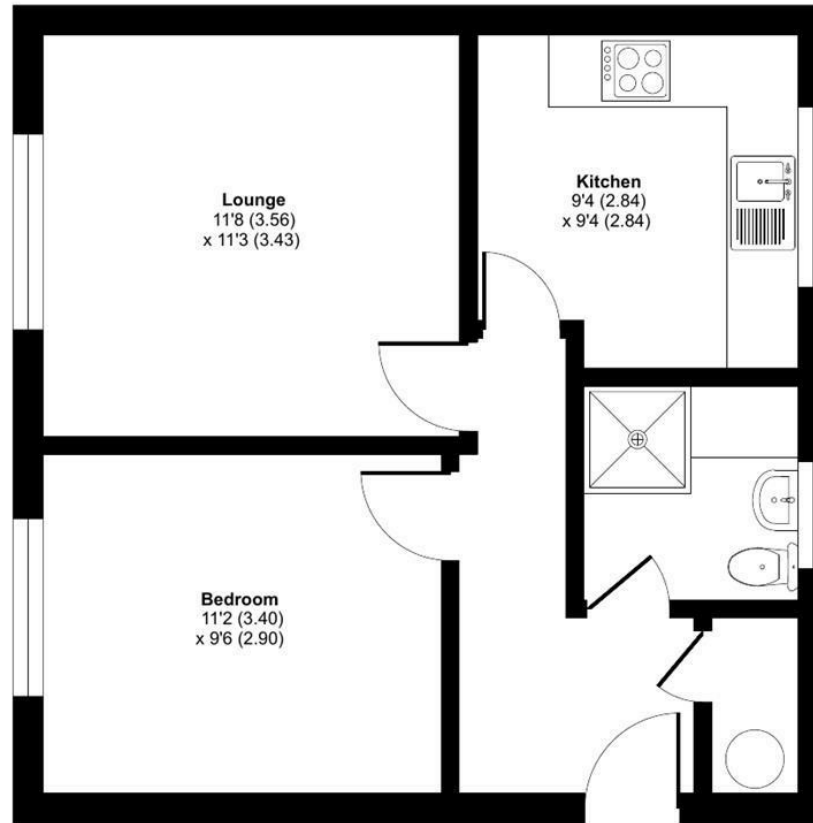

FIRST FLOOR



Floor plan produced in accordance with RICS Property Measurement Standards incorporating International Property Measurement Standards (IPMS2 Residential). © ncheom 2022. Produced for Hollis Morgan. REF: 880813



TEL | 0117 933 9522 | 9 Waterloo Street, Clifton, Bristol BS8 4BT

www.hollismorgan.co.uk | post@hollismorgan.co.uk

Hollis Morgan Property Limited, registered in England, registered no 7275716
Registered address, 5 Upper Belgrave Road, Clifton, Bristol BS8 2XQ

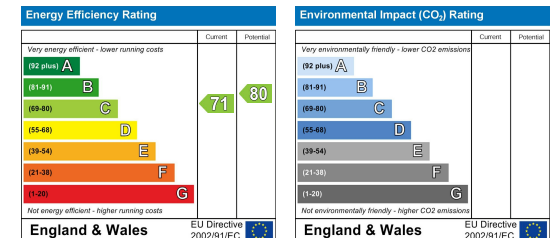

hollis
morgan
